

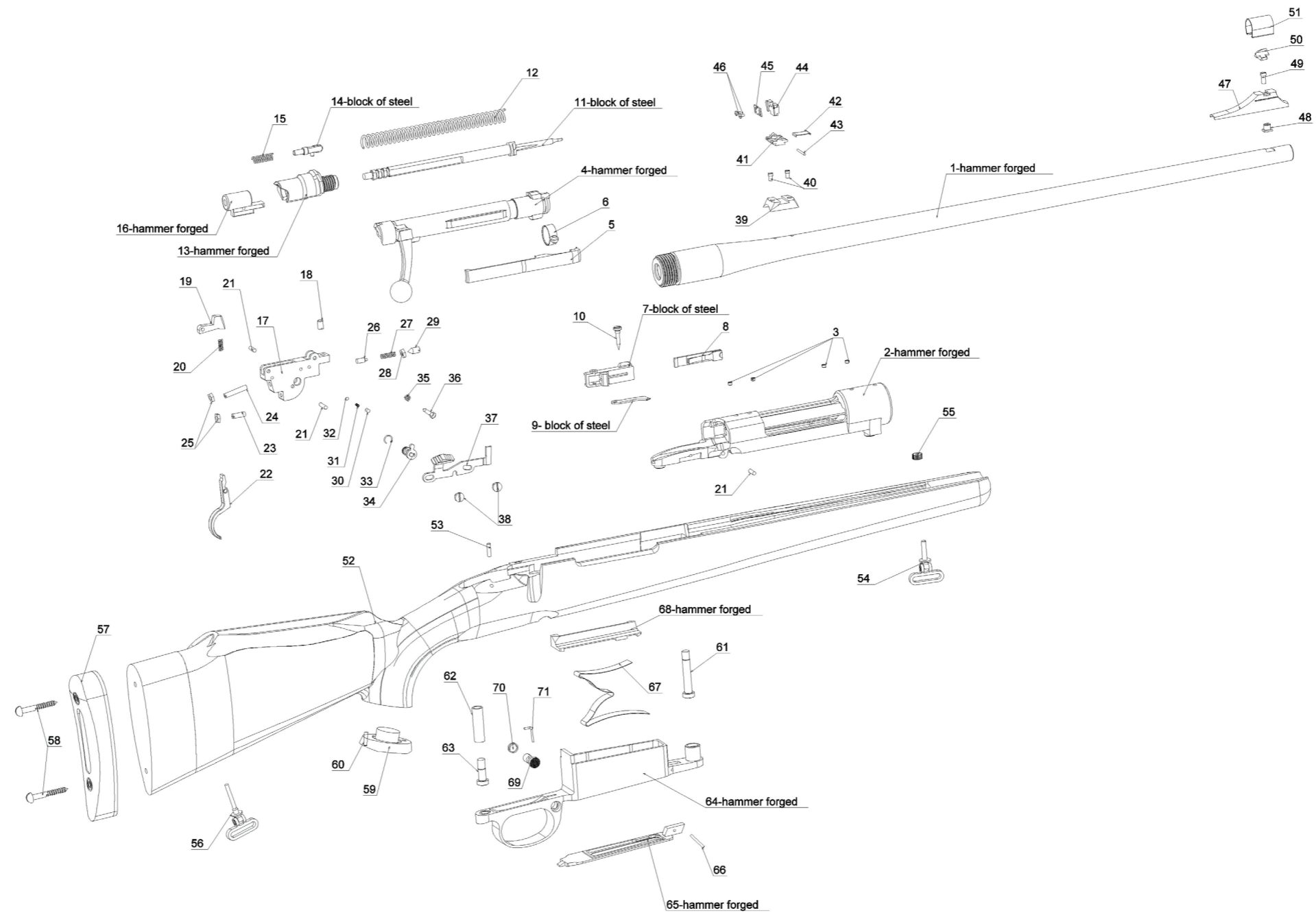

Zastava
a r m s

Sporting rifle
LK M70

EXPLODE PART VIEW



www.zastava-arms.rs

| No. | Part number | Part name |
|-----|-------------|---|
| 1 | | Receiver |
| 2 | | Barrel |
| 3 | 2480 | Plug screw |
| 4 | | Bolt |
| | 8037 | .308 win, .243 Win, .30-06 Spring, .270 Win |
| | 8038 | .300 Win Mag, 7 mm Rem Mag |
| 5 | | Extractor |
| | 1779 | .308 win, .243 Win, .30-06 Spring, .270 Win |
| | 3935 | .300 Win Mag, 7 mm Rem Mag |
| 6 | 1780 | Extractor ring |
| 7 | 1757 | Bolt stop |
| 8 | 1758 | Bolt stop spring |
| 9 | 1759 | Ejector |
| 10 | 1760 | Bolt stop screw |
| 11 | 2276 | Firing pin |
| 12 | 2275 | Firing pin spring |
| 13 | 1800 | Bolt plug |
| 14 | 1801 | Bolt plug retainer |

| No. | Part number | Part name |
|-----|-------------|---------------------------|
| 15 | 1802 | Bolt plug retainer spring |
| 16 | 8045 | Hammer |
| 17 | 1812 | Trigger mech housing |
| 18 | 1818 | Front screw |
| 19 | 1817 | Sear |
| 20 | 1814 | Sear spring |
| 21 | 1816 | Axle pin |
| 22 | 1809 | Trigger |
| 23 | 1811 | Screw lower |
| 24 | 1813 | Screw upper |
| 25 | 1810 | Nut |
| 26 | 1822 | Pusher |
| 27 | 1820 | Pusher nut |
| 28 | 1821 | Pusher spring |
| 29 | 1819 | Pusher screw |
| 30 | 1823 | Ball screw |
| 31 | 1824 | Ball spring |
| 32 | 1825 | Ball |
| 33 | 1826 | Ring |

| No. | Part number | Part name |
|-----|-------------|---------------------------|
| 34 | 1842 | Safety ass. |
| 35 | 1841 | Safety spring |
| 36 | 1840 | Safety screw |
| 37 | 117776 | Safety lever |
| 38 | 1815 | Lever screw |
| 39 | 1797 | Rear sight base |
| 40 | 1798 | Rear sight base screw |
| 41 | 1791 | Rear sight carrier |
| 42 | 1794 | Rear sight spring |
| 43 | 1795 | Rear sight axle pin |
| 44 | 1792 | Rear sight plate carrier |
| 45 | 1793 | Rear sight plate |
| 46 | 1796 | Plate screw |
| 47 | 1787 | Front sight carrier |
| 48 | 1786 | Screw carrier |
| 49 | 1788 | Front sight carrier screw |
| 50 | 1784 | Front sight |
| 51 | 1785 | Front sight guard |

| No. | Part number | Part name |
|-----|-------------|---|
| 52 | | Stock |
| | 113556 | Monte Carlo |
| 53 | 1860 | Stock plug |
| 54 | 7492 | Front swivel |
| 55 | 1871 | Front sling nut |
| 56 | 7493 | Rear swivel |
| 57 | 125907 | Butt stock pad |
| 58 | 4612 | Butt stock pad screw |
| 59 | 113570 | Stok grip protector |
| 60 | 113569 | Grip screw |
| 61 | 4964 | Front screw |
| 62 | 2281 | Rear screw tube |
| 63 | 4963 | Rear screw |
| 64 | | Magazine |
| | 8540 | .308 win, .243 Win, |
| | 4603 | .30-06 Spring, .270 Win, .300 Win Mag, 7 mm Rem Mag |
| 65 | 4607 | Magazine bottom |
| 66 | 1882 | Pin axle |

| No. | Part number | Part name |
|-----|-------------|---|
| 67 | | Follower spring |
| | 2492 | .308 win, .243 Win, |
| | 1879 | .30-06 Spring, .270 Win, .300 Win Mag, 7 mm Rem Mag |
| 68 | | Follower |
| | 2493 | .308 win, .243 Win, |
| | 2288 | .30-06 Spring, .270 Win, .300 Win Mag, 7 mm Rem Mag |
| 69 | 4608 | Magzine release |
| 70 | 4605 | Mag. release spring |
| 71 | 4606 | Retain |